



### COVERING - MODEL VP CHIMNEY ADAPTERS CONNECTING MODEL VP TO EXISTING SELKIRK CHIMNEY INSTALLATION INSTRUCTIONS

Read Sheet VP for important clearance and safety precautions before installing any of the parts described by this sheet. Sheet VP is packaged with Wall Thimbles and Ceiling Supports and is the main Installation Instruction for the VP system.

#### SELKIRK CHIMNEY ADAPTERS (A6 and A8)

Selkirk Chimney Adapters (VP-A6 and VP-A8) are available for use in connecting a Model VP Vent System into an existing Selkirk Chimney system (example: installing a pellet burning appliance to replace another appliance which was connected to Selkirk chimney).

To install: First, check to determine if the chimney already incorporates a smoke pipe adapter. Most Model Selkirk Chimney systems will incorporate a Dripless Smoke Adapter (DSA or DSAC) extending from the chimney inlet. This was used for connecting the appliance in the original installation and will also be used for the VP installation. If no adapter is in place (extending from the chimney inlet), install a Selkirk Model CPA Chimney Pipe Adapter on the chimney inlet.

Install the VP adapter by sliding it over the DSA, DSAC or CPA adapter extending from the chimney inlet. Mark and drill a minimum of three (3) 1/8" diameter holes (equally spaced around the perimeter and approximately 1/2" beneath the top of the VP adapter) through the dripless adapter. Attach adapter by inserting screws through holes (see Fig. 1).

The bottom end of the VP adapter is sized to slide inside the outlet of the corresponding size of Model VP vent section. After completing installation of required sections of Model VP system between adapter and appliance, attach the adapter to Model VP in the same manner.

NOTE: Venting a pellet fueled appliance into an existing oversized chimney may result in a significant slow down in the flow of products of combustion where the vent size increase occurs. This may have an impact upon the operation of the appliance and may result in increased amounts of fine, powdery dust accumulations and/or condensation occurring within the vent system. If such installation is necessary, additional precautions should be taken to check the operation of the appliance and dust accumulation. More frequent cleaning may be necessary.

NOTE: Reference the Appliance Manufacturer's installation instructions to determine if this type of connection is permissible. Follow all local installation codes.

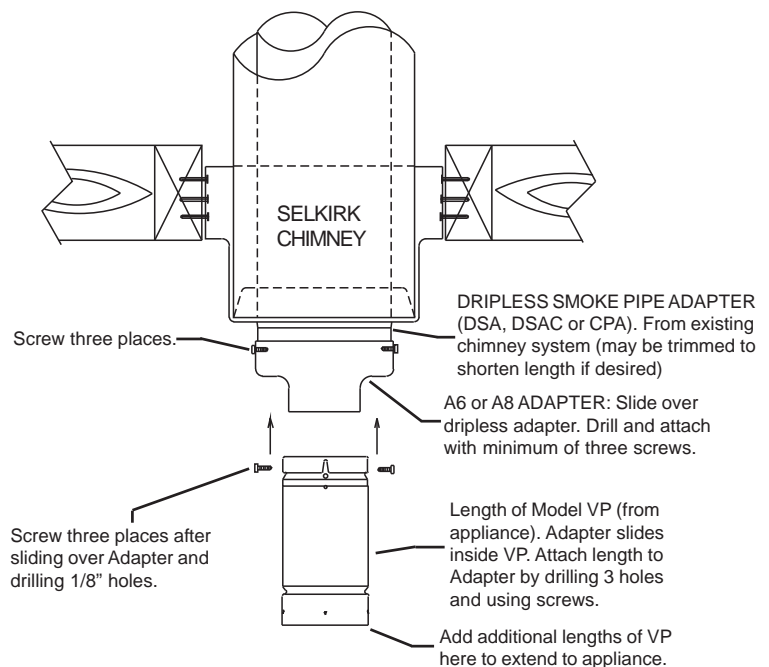

Fig. 1 ATTACHMENT OF VP ADAPTER TO EXISTING SELKIRK CHIMNEY INSTALLATION

#### ⚠ WARNING

Failure to follow the installation instructions could cause FIRE, CARBON MONOXIDE POISONING, OR DEATH. If you are unsure of installation requirements, call the Phone Number listed on the instructions or sizing handbook.